

## General Information

Nemours Estate is open for visitation from April through December.

- ◆ Cameras are permitted
- ◆ Self-guided
- ◆ No food or drink available for purchase
- ◆ Picnics encouraged

## Estate Hours

Tuesday–Sunday, 10 a.m. to 5 p.m.



**NEMOURS ESTATE**  
*Winer & Conaistro*



## Share Your Photos

#nemoursestate

Restrooms

Accessible Restrooms

Parking

Shelter

Accessible Path

- 1 Group Tour Center**  
Group tours begin here.
- 2 Western Lodge**  
Once the gatekeeper's residence, it houses a gate-opening wheel Alfred I. duPont designed.
- 3 Temple of Love**  
The bronze statue of *Diana the Huntress* looks out from this classically-inspired temple.
- 4 Upper Ponds**  
A more informal landscape area, with natural styled ponds, anchored by the Venetian Bridge (1926).
- 5 Sunken Gardens**  
Alfred I. duPont's only son, Alfred Victor duPont, an architect, designed these gardens.
- 6 Colonnade**  
This memorial honors Alfred I. duPont's great-great-grandfather and great-grandfather.
- 7 Maze Garden**  
A maze of arborvitae surrounds the bronze and gold leaf statue of *Achievement*.
- 8 Reflecting Pool**  
The *Four Elements* looked on as the duPonts used this large pool for swimming and boating.
- 9 Vista (The Long Walk)**  
Elk statues, fountain urns, and tree-lined allées frame this magnificent walkway.
- 10 Russian Gates**  
Forged in France, these iron gates stood outside a palace owned by Catherine the Great, Empress of Russia.
- 11 English Gates**  
These 18th-century English gates were once used at Wimbledon Manor outside London.
- 12 Nemours Mansion**  
Designed and built between 1909 and 1910, the 47,000-square foot mansion has 77 rooms.
- 13 Laundry**  
Its equipment served the needs of both the household and the domestic staff.
- 14 Water Tower**  
This tower held 18,000 gallons of water used on the estate and chimed the hours with its clock.
- 15 Chauffeur's Garage**  
Housed here are vintage automobiles, a pony cart and a motor launch used by the duPonts.
- 16 Woodland Trailhead**  
Two trails wind through boulder-strewn hillsides to natural springs and concrete pools.
- 17 Farm Equipment**  
These farm tools were used on the Estate's orchards, produce gardens and nurseries.
- 18 Southern Gardens**  
Three "rooms" — Parterre Garden, Four Borders and Frog Pond — transition from formal to natural.
- 19 New Pump House**  
The huge engine in this building bears a plaque: "Made by Alfred I. duPont 1931."
- 20 Old Pump House**  
This building formerly housed a pump that furnished water to the gardens.
- 21 Lower Ponds**  
These ponds serve as habitats for ducks, herons, songbirds, frogs and turtles.
- 22 Wren's Nest**  
Built in 1915 and expanded to its current size in 1918, this mail-order structure was used as a children's playhouse.
- 23 Rock Garden**  
Flanking a stream that links a series of ponds, this garden contains dwarf conifers and bulbs.







# NEMOURS ESTATE

*Aimer et Connaitre*

## Yours to discover.

### General Information

Nemours Mansion is open for visitation from April through December.

- ◆ Wheelchairs and electric scooters are permitted in the Mansion; some areas may not be accessible
- ◆ Cameras (no flashes) are permitted
- ◆ Strollers are not permitted in the Mansion
- ◆ Self-guided; interpreters stationed at key locations

### Mansion Hours

Tuesday–Sunday, 10 a.m. to 4:30 p.m.



### Share Your Photos

#nemoursestate

### Mansion Second Floor

- 1 North Back Bedroom
- 2 North Front Bedroom
- 3 Brocade Room
- 4 Blue Room
- 5 Gold Room
- 6 Mr. duPont's Bathroom
- 7 Mr. duPont's Sitting Room
- 8 Master Bedroom
- 9 Vestibule
- 10 Mrs. duPont's Sitting Room
- 11 Mrs. duPont's Bathroom
- 12 Venetian Room
- 13 Green Room
- 14 Telephone Closet

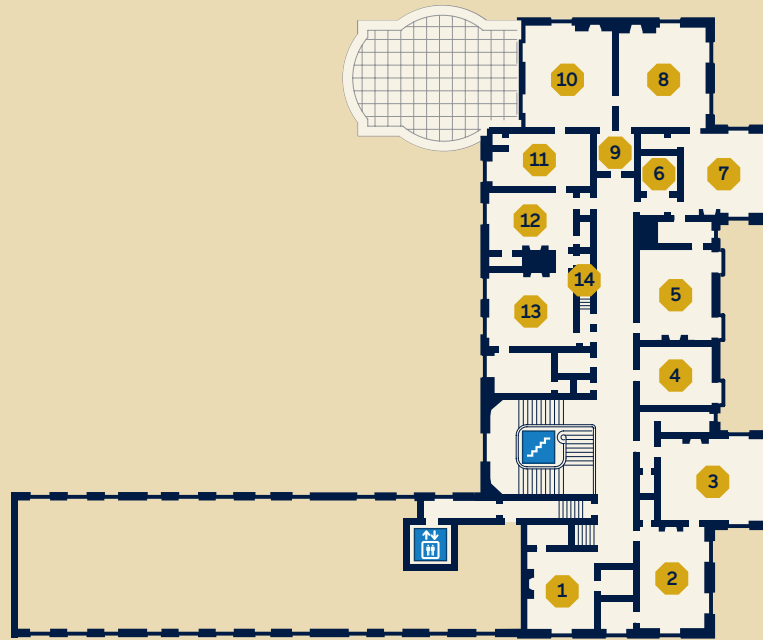

### Mansion First Floor

- 1 Foyer
- 2 Coat Room
- 3 Morning Room
- 4 Drawing Room
- 5 Conservatory
- 6 Music Room
- 7 Reception Hall
- 8 Writing Room
- 9 Library
- 10 Dining Room
- 11 Butler's Pantry
- 12 Kitchen
- 13 Servant's Dining Room
- 14 Servant's Sitting Room

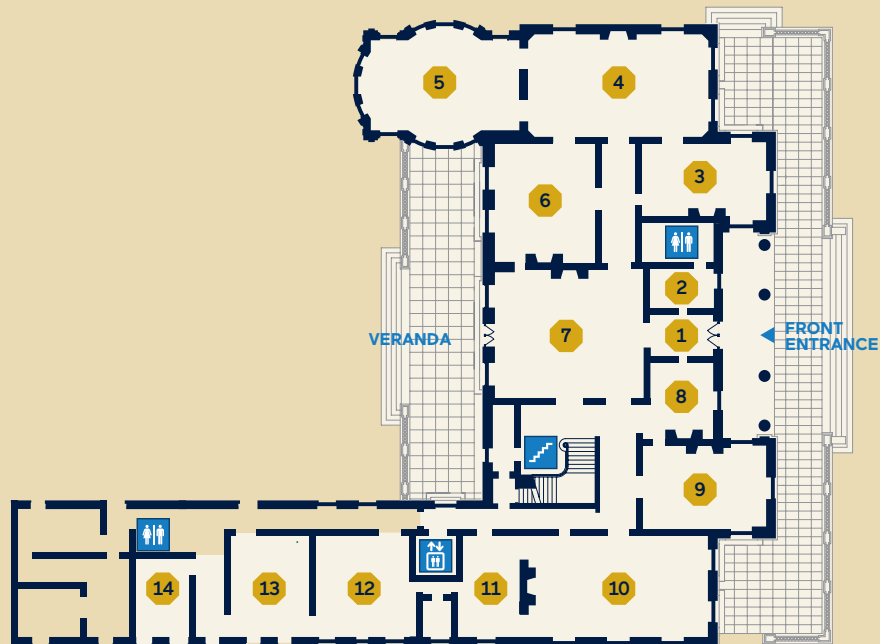

### Mansion Basement

- 1 Shower Room
- 2 Exercise Room
- 3 Shuffleboard Room
- 4 Bowling Alley
- 5 Trophy Hall
- 6 Billiard Room
- 7 Mr. duPont's Office
- 8 Mechanical Rooms

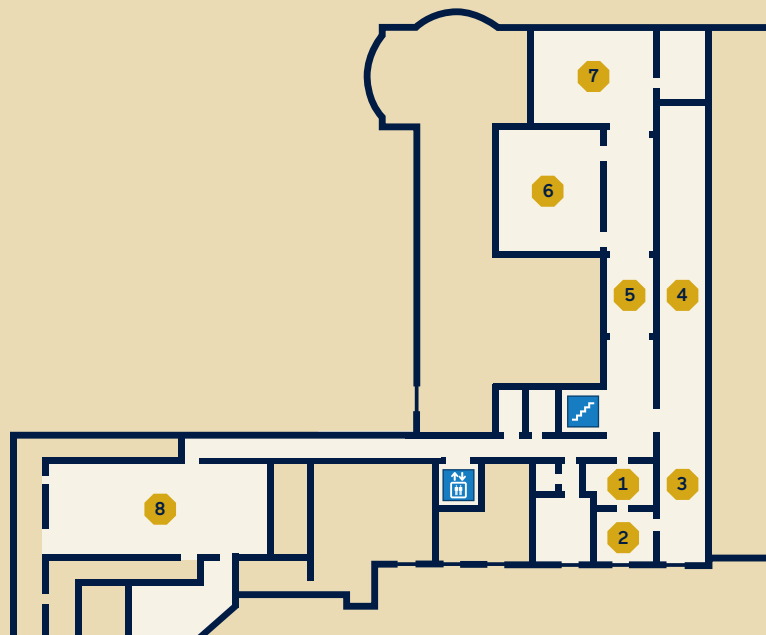

## NEMOURS ESTATE

For assistance please call: 302.651.6912  
In case of emergency please call: 302.651.5560  
Email: [estate@nemours.org](mailto:estate@nemours.org)  
Web: [NemoursEstate.org](http://NemoursEstate.org)